

## SSCSBAV99S7

### Fast Switching Diode

- **Features**

- ✧ Fast Switching Speed
- ✧ Ultra-Small Surface Mount Package
- ✧ Low Reverse Leakage Current
- ✧ Ideal for Battery Powered Portable Applications
- ✧ RoHS Compliant/Green EMC
- ✧ Moisture Sensitivity: Level 3 per J-STD-020

- ✧ **Applications**

- ✧ High speed switching for detection
- ✧ Battery Powered Portable
- ✧ Mobile phones, laptops and other electronic devices

- **PIN configuration**

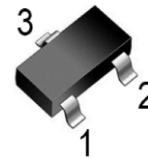

**SOT-323**

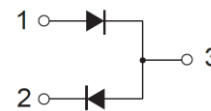

**Circuit Diagram**

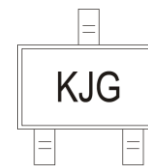

**Marking**

- **Absolute maximum rating @T<sub>A</sub>=25°C**

Parameter	Symbol	Value	Unit
Reverse Voltage(DC)	V <sub>R</sub>	70	V
Average Rectified Forward Current	I <sub>FM</sub>	150	mA
Non-repetitive Peak Forward Surge Current @ t=8.3ms	I <sub>FSM</sub>	2.0	A
Power Dissipation	P <sub>D</sub>	225	mW
Thermal Resistance from Junction to Ambient	R <sub>θJA</sub>	625	°C/W
Junction Temperature	T <sub>J</sub>	125	°C
Storage Temperature	T <sub>STG</sub>	-55 ~ +150	°C



● **Electrical Characteristics @T<sub>A</sub>=25°C**

Parameter	Symbol	Conditions	Min.	Typ.	Max.	Unit
Reverse Voltage	V <sub>R</sub>	I <sub>R</sub> = 100uA	75			V
Forward Voltage	V <sub>F</sub>	I <sub>F</sub> = 1mA			0.715	V
		I <sub>F</sub> = 10mA			0.855	V
		I <sub>F</sub> = 50mA			1	V
		I <sub>F</sub> = 150mA			1.25	V
Reverse Current	I <sub>R</sub>	V <sub>R</sub> = 25V			25	nA
		V <sub>R</sub> = 75V			2.5	μA
Junction Capacitance	C <sub>J</sub>	V <sub>R</sub> = 0V, f = 1MHz			2	pF
Reverse recovery time	t <sub>rr</sub>	I <sub>F</sub> =I <sub>R</sub> =10mA, R <sub>L</sub> =100Ω, I <sub>rr</sub> =0.1I <sub>R</sub>			4	ns

● **Typical Performance Characteristics**

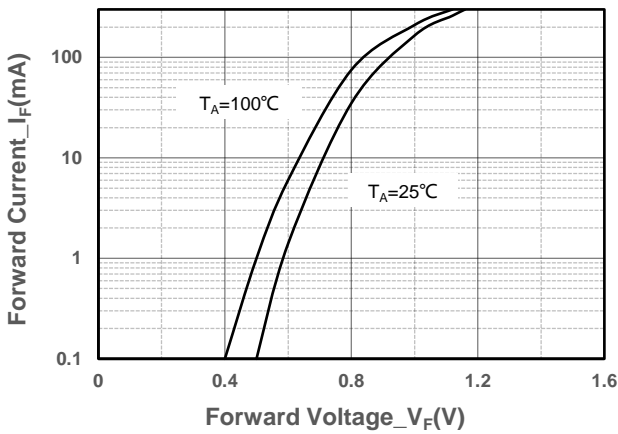

**Forward Current vs. Forward Voltage**

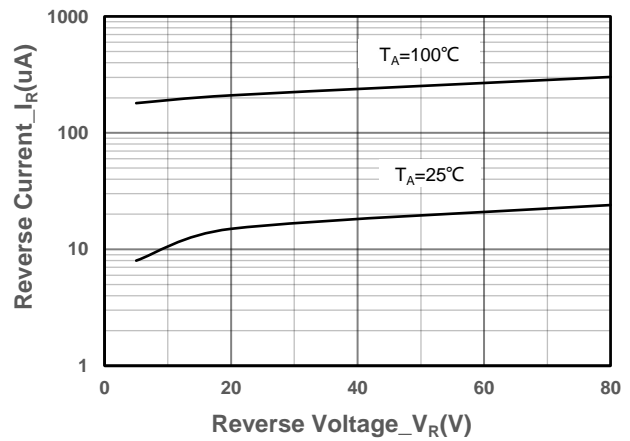

**Reverse Current vs. Reverse Voltage**

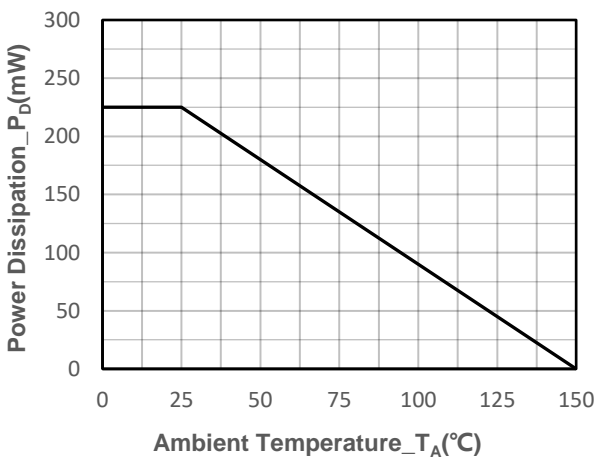

**Power Derating vs. Ambient Temperature**

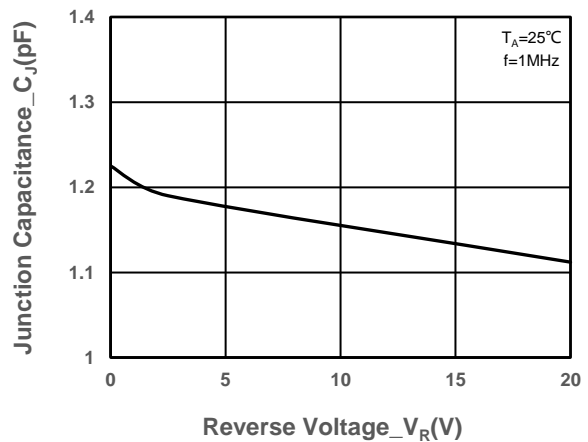

**Junction Capacitance vs. Reverse Voltage**



● **Package Information**

**Ordering Information**

Device	Package	Marking	Qty per Reel	Reel Size
SSCSBAV99S7	SOT-323	KJG	3000	7 Inch

**Mechanical Data**

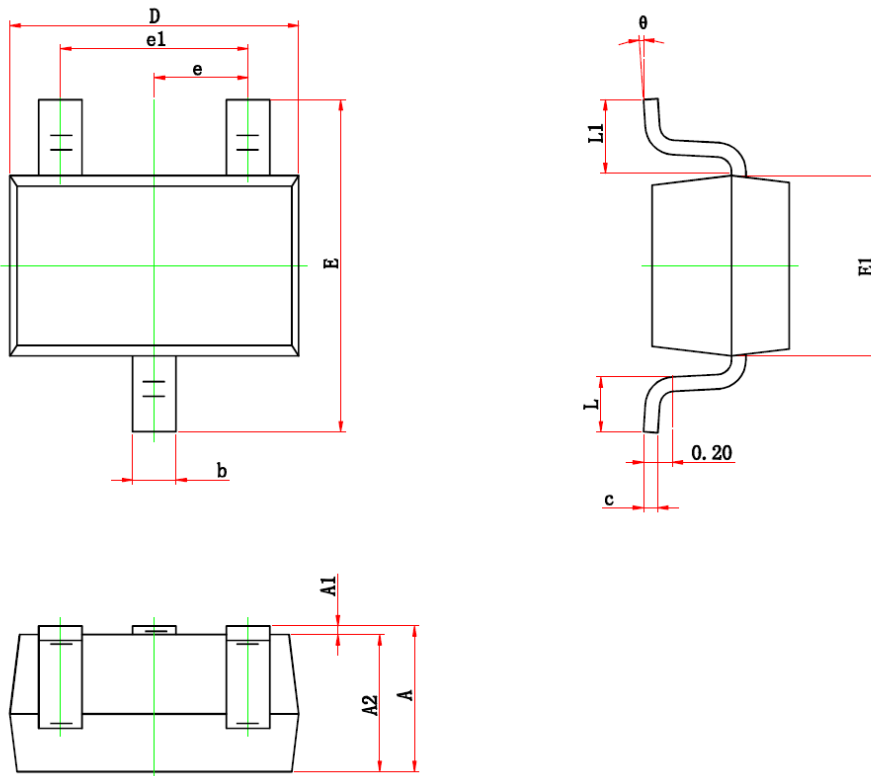

Symbol	Dimensions In Millimeters		Dimensions In Inches	
	Min.	Max.	Min.	Max.
A	0.900	1.100	0.035	0.043
A1	0.000	0.100	0.000	0.004
A2	0.900	1.000	0.035	0.039
b	0.200	0.400	0.008	0.016
c	0.080	0.150	0.003	0.006
D	2.000	2.200	0.079	0.087
E	2.150	2.450	0.085	0.096
E1	1.150	1.350	0.045	0.053
e	0.650 TYP.		0.026 TYP.	
e1	1.200	1.400	0.047	0.055
L	0.260	0.460	0.010	0.018
L1	0.525 REF.		0.021 REF.	
θ	0°	8°	0°	8°



## DISCLAIMER

AFSEMI RESERVES THE RIGHT TO MAKE CHANGES WITHOUT FURTHER NOTICE TO ANY PRODUCTS HEREIN TO IMPROVE RELIABILITY, FUNCTION OR DESIGN. AFSEMI DOES NOT ASSUME ANY LIABILITY ARISING OUT OF THE APPLICATION OR USE OF ANY PRODUCT OR CIRCUIT DESCRIBED HEREIN; NEITHER DOES IT CONVEY ANY LICENCE UNDER ITS PATENT RIGHTS, NOR THE RIGHTS OF OTHERS.

THE GRAPHS PROVIDED IN THIS DOCUMENT ARE STATISTICAL SUMMARIES BASED ON A LIMITED NUMBER OF SAMPLES AND ARE PROVIDED FOR INFORMATIONAL PURPOSE ONLY. THE PERFORMANCE CHARACTERISTICS LISTED IN THEM ARE NOT TESTED OR GUARANTEED. IN SOME GRAPHS, THE DATA PRESENTED MAY BE OUTSIDE THE SPECIFIED OPERATING RANGE (E.G., OUTSIDE SPECIFIED POWER SUPPLY RANGE ) AND THEREFORE OUTSIDE THE WARRANTED RANGE.