



SSCE3V312D3

Bidirectional Micro Packaged TVS Diodes for ESD Protection

● Description

The SSCE3V312D3 is designed to protect voltage sensitive components from ESD. Excellent clamping capability, low leakage, and fast response time provide best in class protection on designs that are exposed to ESD. Because of its small size, it is suited for use in cellular phones, MP3 players, digital cameras and many other portable applications where board space comes at a premium.

It has been specifically designed to protect sensitive components which are connected to data and transmission lines from overvoltage caused by ESD (electrostatic discharge), and EFT (electrical fast transients).

● Feature

- ✧ Peak Power Dissipation—300 W (8 x 20 us Waveform)
- ✧ Replacement for MLV(0603)
- ✧ Protects I/O Port
- ✧ Low Clamping Voltage
- ✧ Low Leakage
- ✧ Low Body Height: 1.68mm
- ✧ Response Time is t_{rr} <math>< 1\text{ ns}</math>
- ✧ Stand-off Voltage: 5.0 V
- ✧ RoHS compliant
- ✧ Meets MSL 1 Requirements
- ✧ Solid-state silicon avalanche technology
- ✧ ROHS compliant
- ✧ Device Meets MSL 1 Requirements

● PIN configuration

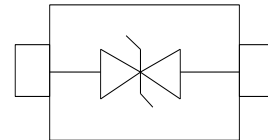

● Applications

- ✧ Cellular handsets and accessories
- ✧ Portable instrumentation
- ✧ Peripherals
- ✧ Serial and Parallel Ports
- ✧ Notebooks, Desktops, Servers
- ✧ Projection TV

● Mechanical data

- ✧ Lead finish: 100% matte Sn(Tin)
- ✧ Mounting position: Any
- ✧ Qualified max reflow temperature: 260 °C
- ✧ Device meets MSL 1 requirements
- ✧ Pure tin plating: 7~17 um
- ✧ Pin flatness: $\leq 3\text{ mil}$

● Protection solution to meet

- ✧ IEC61000-4-2(ESD) $\pm 15\text{ kV}$ (air), $\pm 8\text{ kV}$ (contact)
- ✧ IEC61000-4-4(EFT) 40A(5/50ns)
- ✧ IEC61000-4-5(Surge) 30A(8/20us)



SSCE3V312D3

● Electronic Parameter

Symbol	Parameter
V_{RWM}	Working Peak Reverse Voltage
V_{BR}	Breakdown Voltage @ I_T
V_C	Clamping Voltage @ I_{PP}
I_T	Test Current
I_{RM}	Leakage current at V_{RWM}
I_{PP}	Peak pulse current
C_O	Off-state Capacitance
C_J	Junction Capacitance

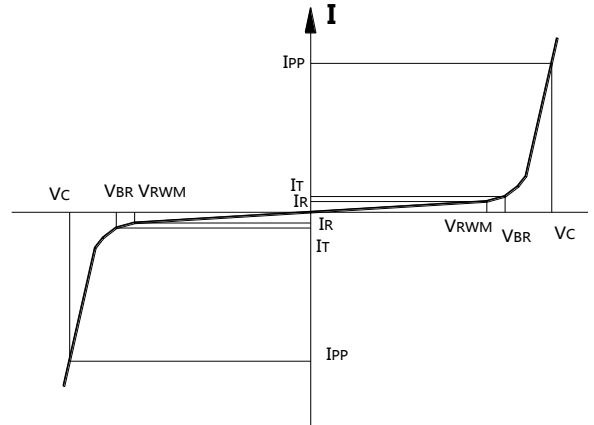

● Absolute maximum rating@TA=25°C

Symbol	Parameter	Value	Units
P_{PPP}	Peak Pulse Power($t_p=8/20\mu s$ waveform)	300	Watts
	ESD Rating per IEC61000-4-2: Contact	30	KV
	Air	30	
T_L	Lead Soldering Temperature	260(10 sec.)	°C
T_J	Operating Temperature Range	-55~150	°C
T_{STG}	Storage Temperature Range	-55~150	°C
T_L	Lead Solder Temperature–Maximum(10 Second Duration)	260	°C

Maximum ratings are those values beyond which device damage can occur. Maximum ratings applied to the device are individual stress limit values (not normal operating conditions) and are not valid simultaneously. If these limits are exceeded, device functional operation is not implied, damage may occur and reliability may be affected.

*Other voltages may be available upon request.

1. Non-repetitive current pulse, per Figure 1.

● Electrical Characteristics@TA=25°C

Device	V_{RWM}	$I_R @ V_{RWM}$		$V_{BR} @ 1 \text{ mA}$	$V_C @ 1 \text{ A}$	$V_C @ 30 \text{ A}$	Capacitance	
		(uA)		(V)	(V)		@ $V_R=0 \text{ V}, 1 \text{ MHz(pF)}$	
		Max	Min	Max	Max	Max	Typ	Max
SSCE3V312D3	3.3	0.1	3.8	6.0	5	10	52	70

Junction capacitance is measured in $V_R=0V, F=1MHz$



- **Typical Performance Characteristics**

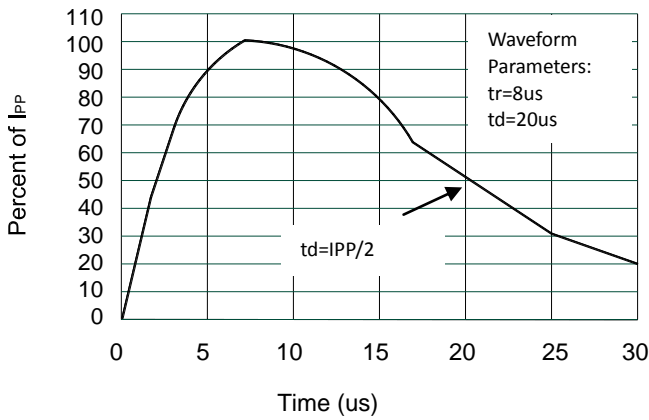

Pulse Waveform

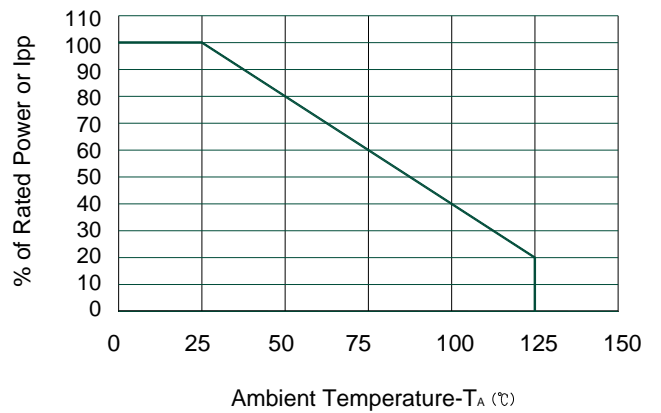

Power Derating Curve

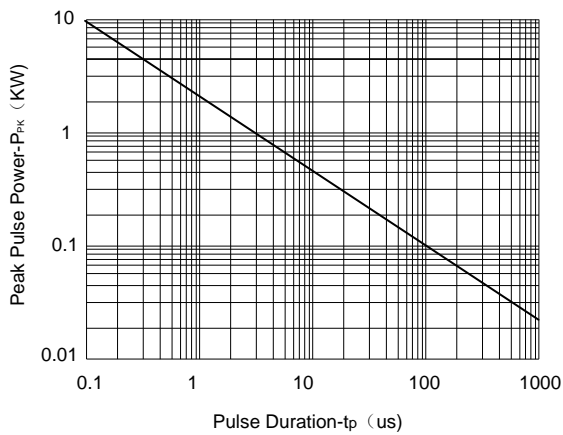

Non-Repetitive Peak Pulse Power vs. Pulse Time

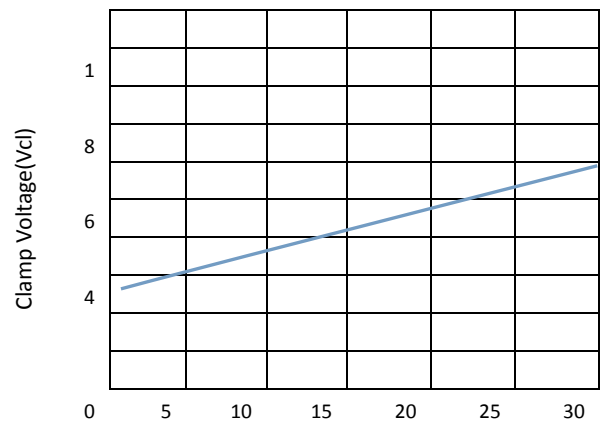

Clamping Voltage Vs Peak Pulse Current(IPP)

Peak pulse current, IPP(A)



SSCE3V312D3

- **Solder Reflow Recommendation**

Peak Temp=257°C,Ramp Rate=0.802deg.°C/sec

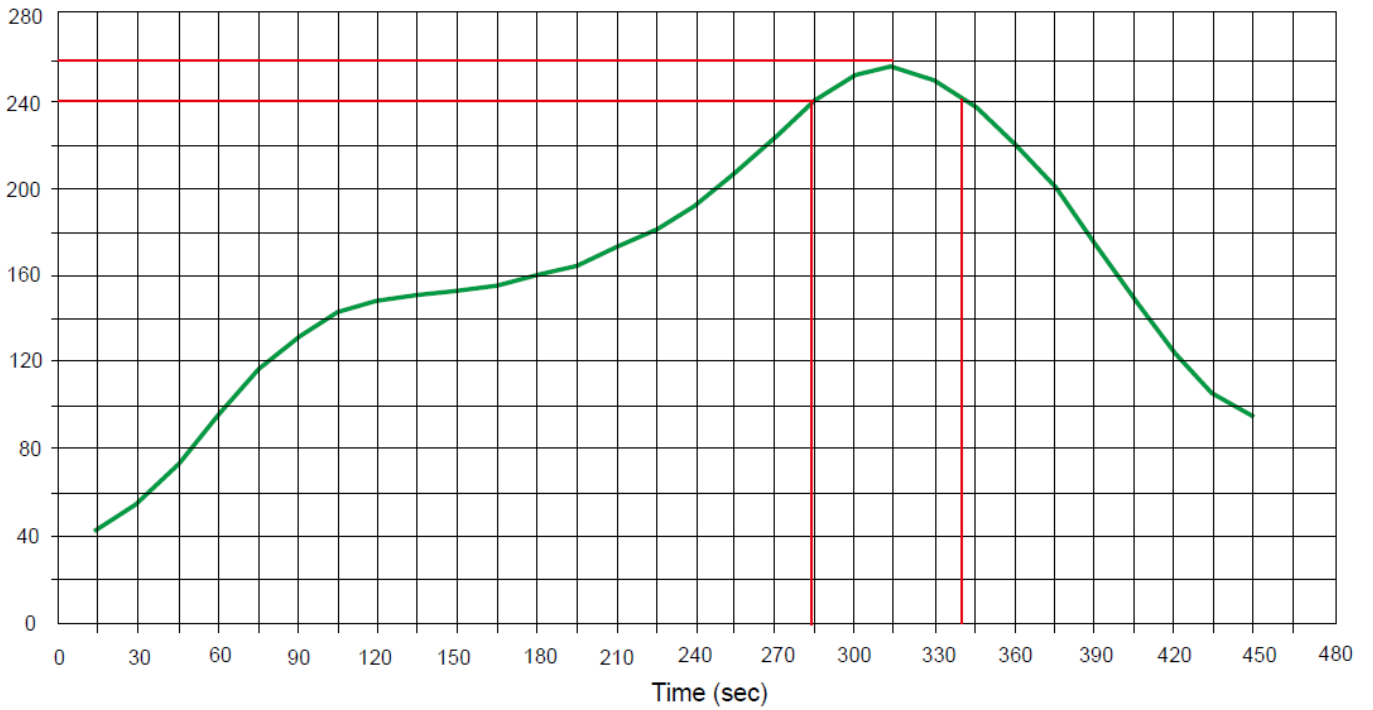



SSCE3V312D3

● Package Information

Ordering Information

Device	Package	Qty per Reel	Reel Size	Marking
SSCE3V312D3	SOD-523	3000	7 Inch	3Q

Mechanical Data

Case:SOD-523

Case Material:Molded Plastic.UL Flammability

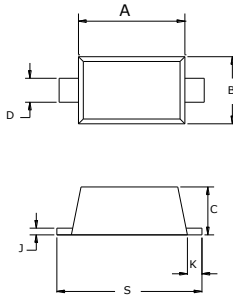

DIM	Millimeters	
	Min	Max
A	1.10	1.30
B	0.75	0.85
C	0.51	0.70
D	0.25	0.35
J	0.08	0.15
K	0.15	0.25
S	1.50	1.70

Recommended Pad outline

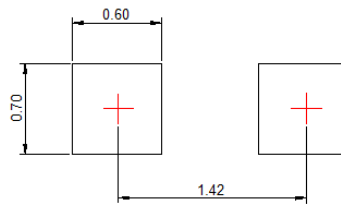



SSCE3V312D3

DISCLAIMER

AFSEMI RESERVES THE RIGHT TO MAKE CHANGES WITHOUT FURTHER NOTICE TO ANY PRODUCTS HEREIN TO IMPROVE RELIABILITY,FUNCTION OR DESIGN.AFSEMI DOES NOT ASSUME ANY LIABILITY ARISING OUT OF THE APPLICATION OR USE OF ANY PRODUCT OR CIRCUIT DESCRIBED HEREIN;NEITHER DOES IT CONVEY ANY LICIENCE UNDER ITS PATENT RIGHTS,NOR THE RIGHTS OF OTHERS.

THE GRAPHS PROVIDED IN THIS DOCUMENT ARE STATISTICAL SUMMARIES BASED ON A LIMITED NUMBER OF SAMPLES AND ARE PROVIDED FOR INFORMATIONAL PURPOSE ONLY.THE PERFORMANCE CHARACTERISTICS LISTED IN THEM ARE NOT TESTED OR GUARANTEED.IN SOME GRAPHS,THE DATA PRESENTED MAY BE OUTSIDE THE SPECIFIED OPERATING RANGE(E.G,.OUTSIDE SPECIFIED POWER SUPPLY RANGE)AND THEREFORE OUTSIDE THE WARRANTED RANGE.